

THIS MAP COMPLIMENTS OF:



GENE HART
OWNER



BILL HINTZ
OWNER



RON ANDERLY
OWNER



JON O'NEIL
OWNER



FIRST CHOICE

217 E. ELM, WASECA, MN 56093

507-835-4040

Fax 507-835-4103

www.c21waseca.com

Waseca Area Chamber of Commerce
108 East Elm Ave.
Waseca, Minnesota 56093
Phone 507-835-3260

CITY OF WASECA

The city of Waseca, Minnesota is ideally located on two trunk highways. Hwy. 14 running east and west and Hwy. 13 running north and south, both bring many visitors to the community. A short 13 miles away lies Interstate 35 providing a link for Waseca's 8,500 residents to cultural, business, and sporting activities of the Twin City Metro Area only 1 1/2 hours away. Only 30 miles to the south lies Interstate 90 allowing for access to other areas in the midwest.

Waseca is the county seat of Waseca County which has a population of 18,100.

Waseca has a bond rating of "A", and insurance classification of seven. The City provides police and fire protection, street maintenance, and other necessary services.

Electricity and power are provided by the city's Water and Light Department or by Northern States Power Company and natural gas by Minnegasco.

The Waseca Post Office ranks third in the State of Minnesota with annual postal receipts over twenty million dollars.

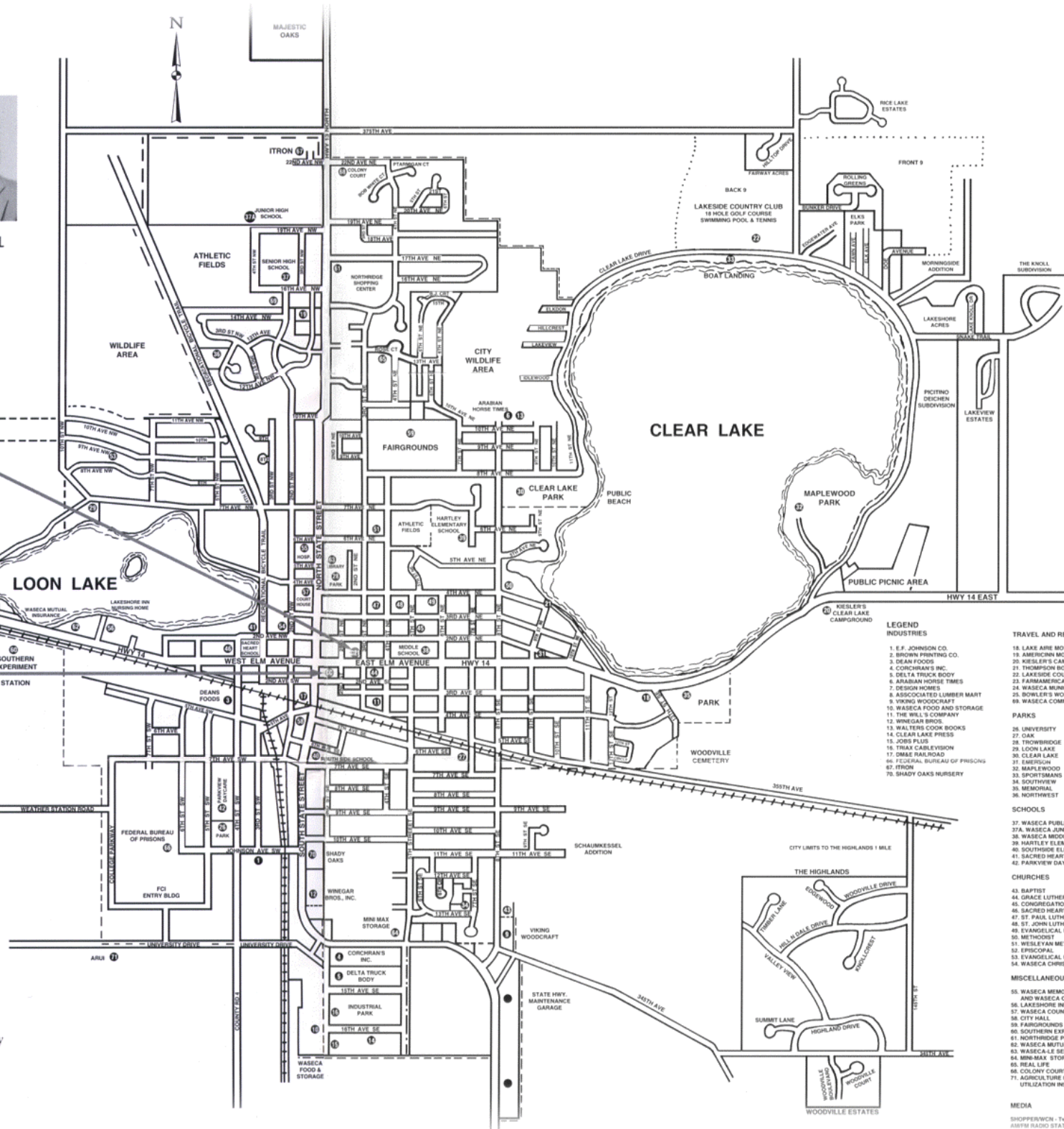

- LEGEND**
- INDUSTRIES**
1. E.F. JOHNSON CO.
 2. BROWN PRINTING CO.
 3. DEAN FOODS
 4. CORCHRAN'S INC.
 5. DELTA TRUCK BODY
 6. ARABIAN HORSE TRIMS
 7. DESIGN HOMES
 8. ASSOCIATED LUMBER MART
 9. VIKING WOODCRAFT
 10. WASECA FOOD AND STORAGE
 11. THE WELLS COMPANY
 12. WINEGAR BROS.
 13. WALTERS COOK BOOKS
 14. CLEAR LAKE PRESS
 15. JOBS PLUS
 16. TRIM CARLEYSON
 17. DRAKE RAILROAD
 18. FEDERAL BUREAU OF PRISONS
 19. SHADY OAKS NURSERY
- TRAVEL AND RECREATION**
18. LAKE ARBE MOTEL
 19. AMERICINN MOTEL
 20. KESLER'S CAMPGROUND
 21. THOMPSON BOAT HOUSE
 22. LAKEVIEW ESTATES
 23. FARMERDICA
 24. WASECA MUNICIPAL AIRPORT
 25. BOWLER'S WORLD
 26. WASECA COMMUNITY ARENA
- PARKS**
26. UNIVERSITY
 27. OAK
 28. TROWBRIDGE
 29. LOON LAKE
 30. CLEAR LAKE
 31. EMERSON
 32. MAPLEWOOD
 33. SPORTSMANS
 34. SOUTHWEST
 35. MEMORIAL
 36. NORTHWEST
- SCHOOLS**
37. WASECA PUBLIC HIGH SCHOOL
 - 37A. WASECA JUNIOR HIGH SCHOOL
 38. WASECA MIDDLE SCHOOL
 39. HARTLEY ELEMENTARY
 40. SOUTHSIDE ELEMENTARY
 41. SACRED HEART ELEMENTARY
 42. FAIRVIEW DAY CARE CENTER
- CHURCHES**
43. BAPTIST
 44. GRACE LUTHERAN
 45. CONGREGATIONAL
 46. SACRED HEART CATHOLIC
 47. ST. PAUL LUTHERAN
 48. ST. JOHN LUTHERAN
 49. EVANGELICAL UNITED BRETHREN
 50. METHODIST
 51. WESLEYAN METHODIST
 52. EPISCOPAL
 53. EVANGELICAL FREE
 54. WASECA CHRISTIAN ASSEMBLY
- MISCELLANEOUS**
55. WASECA MEMORIAL HOSPITAL AND WASECA CLINIC
 56. LAKEVIEW INN NURSING HOME
 57. WASECA COUNTY COURTHOUSE
 58. CITY HALL
 59. FAIRGROUNDS
 60. SOUTHERN EXPERIMENT STATION
 61. NORTHBRIDGE PLAZA
 62. WASECA MUTUAL LIFE INSURANCE CO.
 63. WASECA-LE SEURER REGIONAL LIBRARY
 64. MINN-MAX STORAGE
 65. REAL LIFE
 66. COLONY COURT
 67. AGRICULTURE RESEARCH UTILIZATION INSTITUTE
- MEDIA**
- SHOPPERSON - Twin Weekly
 - AMSTW RADIO STATION - KOWO